



COWPER & NEWTON MUSEUM

Registered Charity No. 310521

Group Visits and Talks 2024



Dear Group Organiser/ Talk Organiser,

The Cowper & Newton Museum is now taking bookings for group visits and talks.

We offer a range of inspiring tours in the museum and gardens. Our talks are fascinating! Please see our website for all those we offer. Both tours and talks can be tailored to suit the interests of your group.

Please complete our booking form and return to us at the address below, or send an email to:
group@cowperandnewtonmuseum.org.uk.

Please do not hesitate to contact me to discuss tours and talks within the museum and gardens and around Olney town. If you have not received a response to your request within 3 days, please ring 01234 711516.

We look forward to seeing you soon!

Yours sincerely,

Paula Noble
House Manager

Please note that there is 3-hour parking on the Market Square outside the museum, 1 hour on the side roads next to the Market Square, unlimited time further up the High Street and there is no parking on the Market Square 2am-6pm every Thursday and 1st Sunday of each month. All parking is free in Olney!

The Cowper & Newton Museum, Orchard Side, Market Place, Olney, MK46 4AJ

Email: group@cowperandnewtonmuseum.org.uk Telephone: 01234 711516

Website: www.cowperandnewtonmuseum.org.uk/



@cowpnewtmuseum

Entertainment and intrigue for all ages

Help Mary find her beautiful silk shoes so she can go to the party tonight. Search high and low for William's pet hares. Get into character - put on your Georgian glad rags.

Tranquil gardens

So much to discover in the gardens

12. The Walled Flower Garden

A beautiful sensory garden with plants from pre-1800 species. Take a seat in this peaceful place to discuss life with the hares as Cowper did, and admire the view of Olney's fine parish church.

13. The Summer House Garden

Featuring Cowper's 'verse manufactory', an original 18th century summer house set in an organically tended heritage fruit, herb and vegetable garden echoing its use as a medicinal garden in Cowper's time. Discover the secret hidden under the floorboards of the Summer House.

14. Olney Parish Church

From the gardens, look out for the impressive 14th century church where Newton was curate.

Some of the Greatest Stories of the Era

Historic townhouse

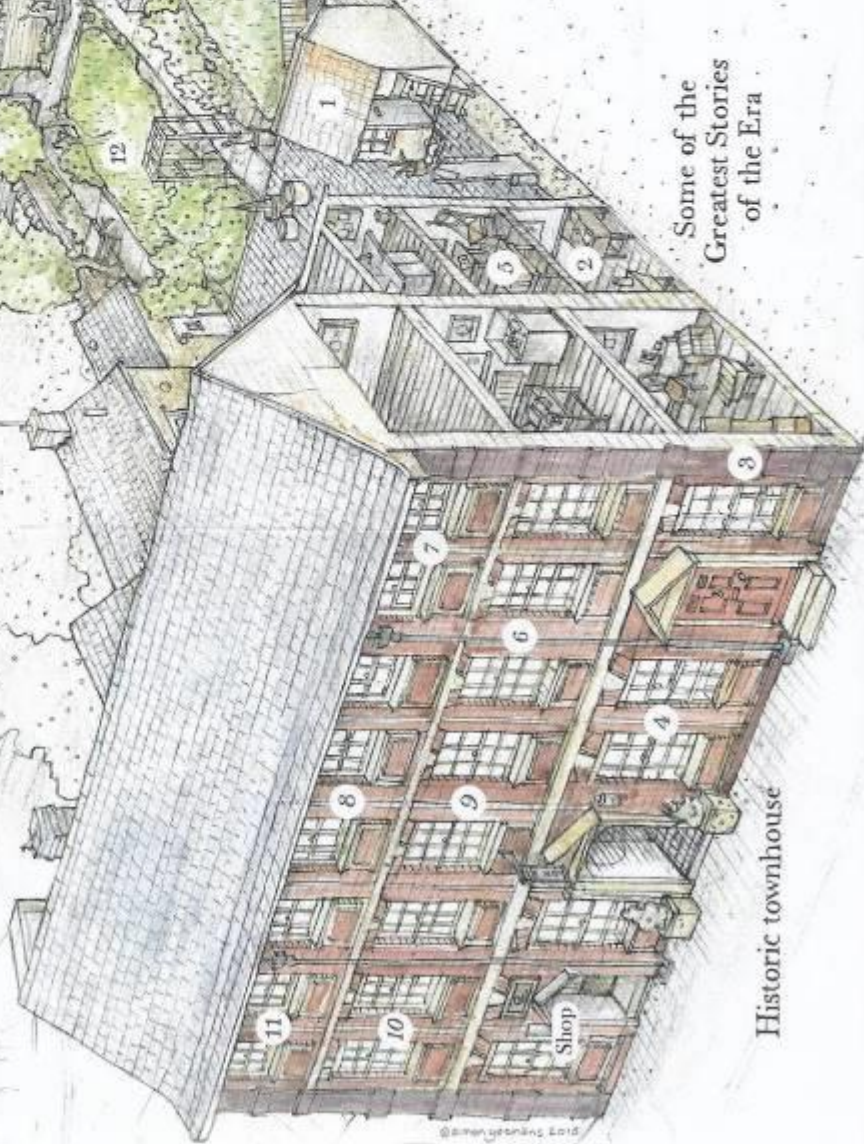

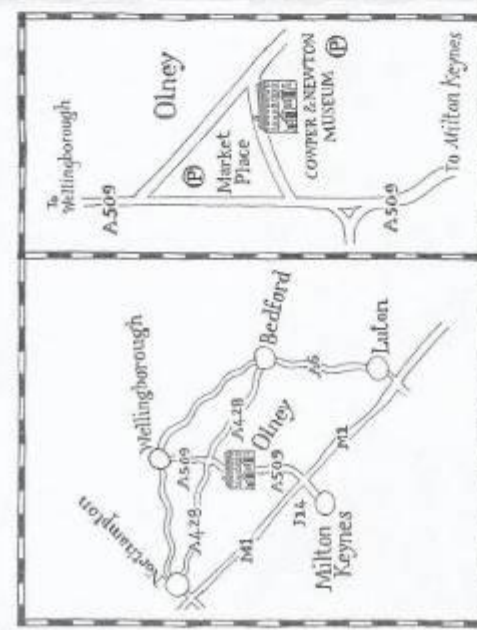

Cowper & Newton Museum
 Orchard Side, Market Place,
 Olney, MK46 4AJ
 Telephone: 01234 711516
 Email: info@cowperandnewtonmuseum.org.uk
www.cowperandnewtonmuseum.org.uk
 See us on Facebook.com/CowpNewtMuseum,
 Instagram.com/cowpernewtonmuseum
 and Twitter @CowpNewtMuseum

Opening times:
 Tuesday to Saturday
 (see website for details, including admission charges)

Guided tours:
 Guided tours and group visits welcome by appointment

Wheelchair access:
 Viper Barn, Courtyard, Gardens, Shop and Toilet

Registered charity: 310521



COWPER & NEWTON MUSEUM

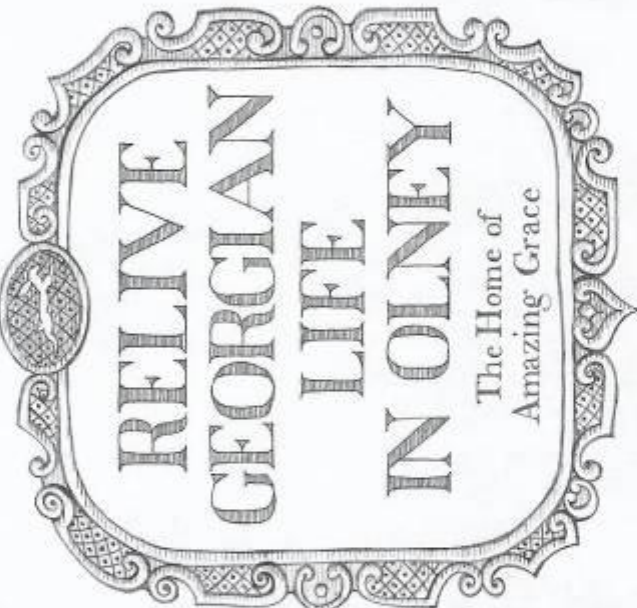

Historic townhouse,
 Tranquil gardens
 and some of the
 Greatest Stories
 of the Era



Cowper's Sofa



Georgian Party Dress

Relive Georgian Life in Olney

Walk back in time through the home of William Cowper, renowned 18th century poet, featuring numerous personal artefacts and belongings. Discover Cowper's comic sense of humour, his poetry and writings, his dark depressions and his love of gardening and animals - especially his pet hares.

"Absence of occupation is not rest;
 A mind quite vacant is a mind distressed."
 William Cowper



Lady Austen's Fan



Cameo Ring in Case

Relax in the Tranquil Gardens

Enjoy the sensory pleasures of two peaceful gardens. The historically significant walled flower garden with its numerous plants, shrubs and flowers of pre-1800 species. The Summer House Garden with its 300 year old garden house, medicinal plants, herbs and heritage fruit and vegetables all maintained organically.

"They whom truth and wisdom lead,
 can gather honey from a weed"
 William Cowper

COWPER & NEWTON MUSEUM

GROUP RATES – 2024

Group of 10 and more to be pre-booked:

group@cowperandnewtonmuseum.org.uk / 01234 711516

OPTION	Adults	Children under 16 years accompanied by a fee-paying Adult	Additional cost
Self led Museum and gardens using previously purchased annual pass	Free - readmission	Free	N/A
Self led Museum and gardens Purchase an annual pass online to re-visit as often as you like throughout the year	£10	Free	N/A
Self led Museum and gardens Does not include an annual pass	£9	Free	N/A
Self led Gardens only	£3.50	Free	N/A
Book a Tour Guide 30 min talk + will stay for the duration of your visit to answer questions	Adult fee + Additional Cost	Free	£30
Room stewards (for large groups of 20 or more) subject to volunteer availability	Adult fee + Additional Cost	Free	£30
Pre- booked Olney Town Tour Subject to guide availability (Does not include museum and garden tour)	£9	Free	Tour guide fee included in the price (1-4 people, minimum fee £30)

Group organiser	Free	Free	N/A
Deposit to be deducted from overall fee, or retained should cancellation be less than 1 week's notice			£25

Schools, External Talks, Refreshments and Shop

<p>1. School talks / Scouts and Guides / Home School Groups</p> <p>Child 5-16 years</p>	<p>Educational visits to museum or to your school – Sessions up to 1.5 hours.</p> <p>£3 per child: 10 children and over or £30 minimum fee: 9 children and under £0: One free adult to every 5 children £9 per (from 17 years) per additional adult accompanying children.</p> <p>Our rooms are small - children will be split into groups. Please make sure each group is accompanied by a DBS checked adult.</p>
2. Academic Research	<p>Academic research visit – please contact the Museum to discuss fee. Previously purchased Annual Admission Ticket and all 2-for-1 Passes NOT VALID</p>
3. External Talks	<p>£75 per talk in person or online.</p> <p>25p per mile – travel expenses (occasionally it is necessary to levy a charge to cover transport costs)</p>
4. Refreshments	<p>£4 per person.</p> <p>Must be pre-booked. Tea, coffee and biscuits in the museum Courtyard (May to Sept)</p>
5. Pre-order Shop items before your visit	<p>Our museum shop has unique items and great gift ideas. View a selection of these on our website – click on 'Visit Us!' and 'The Shop'. You can pre-order ready to collect on your visit – 01234 711516 24 hours notice.</p>

COWPER & NEWTON MUSEUM

Your details

Trip/ Programme/ Coach organiser:			
Phone:			
Email:			
Name of Club/ Group visiting:			
Club/ Group Leader:			
Leader phone:			
Leader email:			
Leader Address (if not on email):			
Date of visit/ talk:			
Your itinerary:	Arrival time:	Departure time:	Refreshment time:
Number in Group:	Adults:	Children:	Age of children:
Venue address for Talks:			
Theme/ Special request:			
*Special access needs:			
How did you hear about us?			

Requests (tick, bold, red text or circle your choices): All subject to Volunteer availability

Tour Guide talk, then self-led in museum and gardens	Tour Guide talk and guided in museum and gardens (for smaller groups)	Tour Guide talk, then self-led in gardens	Tour Guide talk and guided in gardens (for smaller groups)
Self-led tour No Tour Guide	Olney Town tour with Tour Guide – extra cost to museum and garden tour	School trip (details to be discussed separately)	Academic Research Visit
Talk at Group's Venue/ other venue	Talk via online via Zoom	Refreshments (May- Sept served outside)	Bring Pop-Up Shop to the Talk's venue

How to pay (circle your choices): Pounds (£) sterling. Pay 'Cowper Memorial Museum'

Bacs payment <i>Sort code 20-05-74 A/C 80294616</i>	Raise an invoice for our Treasurer:	Raise an invoice to match the voucher from the group leader on visit day	Cheque no enclosed:
Credit card (1) by email payment link (2) on the day	Deposit £25 paid date: Cheque no:	Balance left to pay: Date paid:	

*As we are a volunteer-run charity with no external funding it would be appreciated if you could pay **BEFORE** your visit. **If paying by cash on the day, please bring the correct change to speed up the admission process.***

- * **Disabled access:** Wheelchair/mobility scooter access to Viper Barn (short intro film). Cowper's Kitchen, Hall and Parlour accessible by 1-2 shallow steps. Short films to watch in the Shop area for those unable to manage our stairs (over 3 floors). Museum has 6 small flights of stairs. Gardens have some narrow uneven paths. If you have people in your party that may struggle to keep up with a guided tour, the Tour Guide talk followed by the self-led option allows groups to go at their own pace.

To visit St Peter and St Paul Church: Contact the Church Administrator on 01234 241721 or office@olneyparish.org.uk

OFFICE USE ONLY	Booking request date: Confirmed booking with organiser date: Acknowledged receipt of deposit <input type="checkbox"/> balance <input type="checkbox"/> St Peter and St Paul Church informed: Yes/ No	Name(s) of Tour Guides/ Stewards: Name of Refreshment organiser:	On calendar: Yes/ No On G&E spreadsheet date: Veranda needed? Yes/ No In costume: Yes/ No
------------------------	---	---	--