



COWPER & NEWTON MUSEUM

Registered Charity No. 310521

## Group Visits and Talks 2023



Dear Group and Talk Organiser,

The Cowper & Newton Museum is now taking bookings for group visits and talks.

We offer a range of inspiring tours in the museum and gardens. Our talks are fascinating! Please see our website for all those we offer. Both tours and talks can be tailored to suit the interests of your group.

Please complete our booking form and return to us at the address below, or send an email to: [house-manager@cowperandnewtonmuseum.org.uk](mailto:house-manager@cowperandnewtonmuseum.org.uk).

Please do not hesitate to contact me to discuss tours and talks within the museum and gardens and around Olney town. If you have not received a response to your request within 3 days, please ring 01234 711516.

We look forward to seeing you soon!

Yours sincerely,

Paula Noble  
House Manager

Please note that there is 3-hour parking on the Market Square outside the museum, 1 hour on the side roads next to the Market Square, unlimited time further up the High Street and there is no parking on the Market Square 2am-6pm every Thursday and 1<sup>st</sup> Sunday of each month. All parking is free in Olney!

The Cowper & Newton Museum, Orchard Side, Market Place, Olney, MK46 4AJ

Email: [group@cowperandnewtonmuseum.org.uk](mailto:group@cowperandnewtonmuseum.org.uk) Telephone: 01234 711516

Website: [www.cowperandnewtonmuseum.org.uk/](http://www.cowperandnewtonmuseum.org.uk/)



@cowpnewtmuseum

## Entertainment and intrigue for all ages

Help Mary find her beautiful silk shoes so she can go to the party tonight. Search high and low for William's pet hares. Get into character - put on your Georgian glad rags.

## Tranquil gardens

## So much to discover in the gardens

### 12. The Walled Flower Garden

A beautiful sensory garden with plants from pre-1800 species. Take a seat in this peaceful place to discuss life with the hares as Cowper did, and admire the view of Olney's fine parish church.

### 13. The Summer House Garden

Featuring Cowper's 'verse manufactory', an original 18th century summer house set in an organically tumbled heritage fruit, herb and vegetable garden echoing its use as a medicinal garden in Cowper's time. Discover the secret hidden under the floorboards of the Summer House.

### 14. Olney Parish Church

From the gardens, look out for the impressive 14th century church where Newton was curate.

## Some of the Greatest Stories of the Era

## Historic townhouse

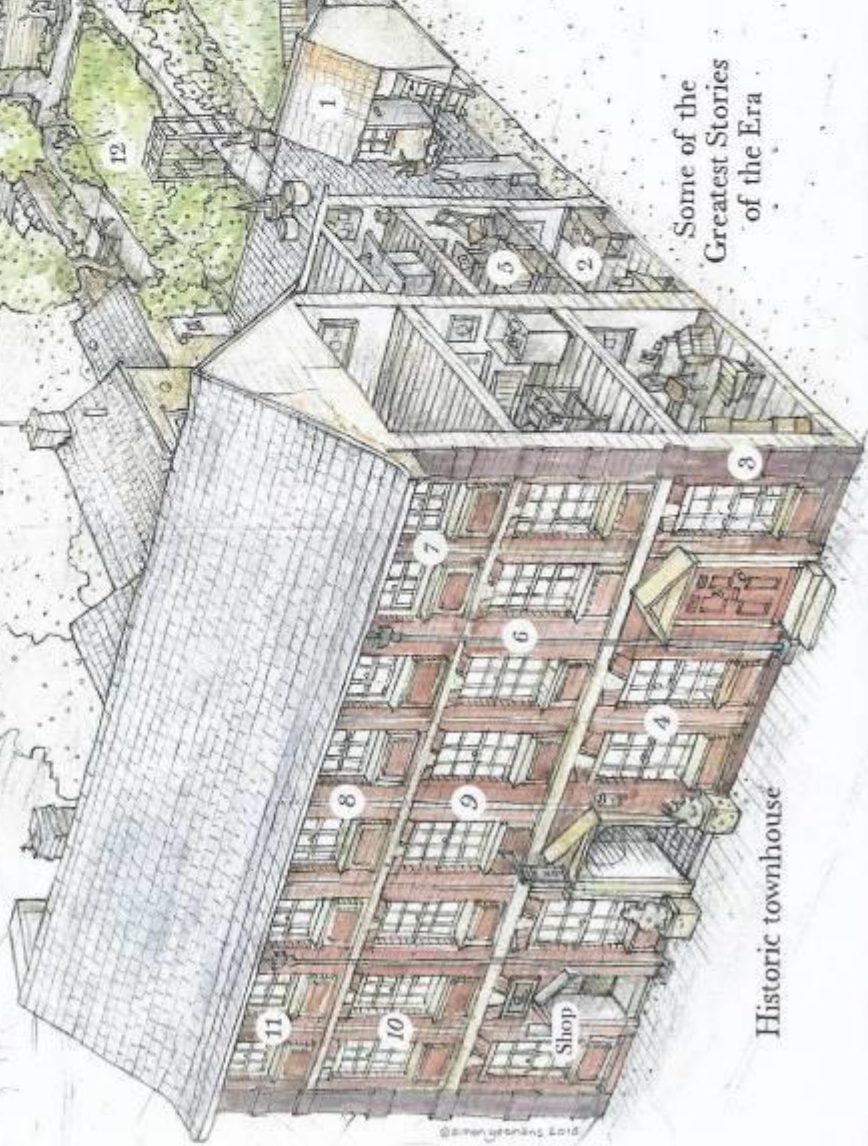

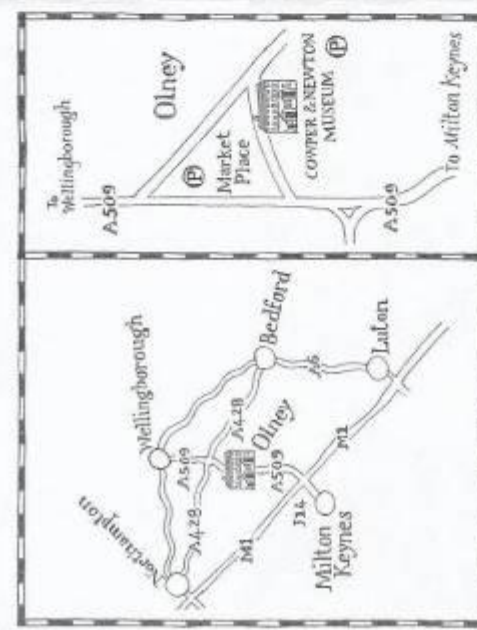

**Cowper & Newton Museum**  
 Orchard Side, Market Place,  
 Olney, MK46 4AJ  
 Telephone: 01234 711516  
 Email: [info@cowperandnewtonmuseum.org.uk](mailto:info@cowperandnewtonmuseum.org.uk)  
[www.cowperandnewtonmuseum.org.uk](http://www.cowperandnewtonmuseum.org.uk)  
 See us on Facebook.com/CowpNewtMuseum,  
 Instagram.com/cowpernewtonmuseum  
 and Twitter @CowpNewtMuseum

**Opening times:**  
 Tuesday to Saturday  
 (see website for details, including admission charges)

**Guided tours:**  
 Guided tours and group visits welcome by appointment

**Wheelchair access:**  
 Viper Barn, Courtyard, Gardens, Shop and Toilet

Registered charity: 310521



## COWPER & NEWTON MUSEUM

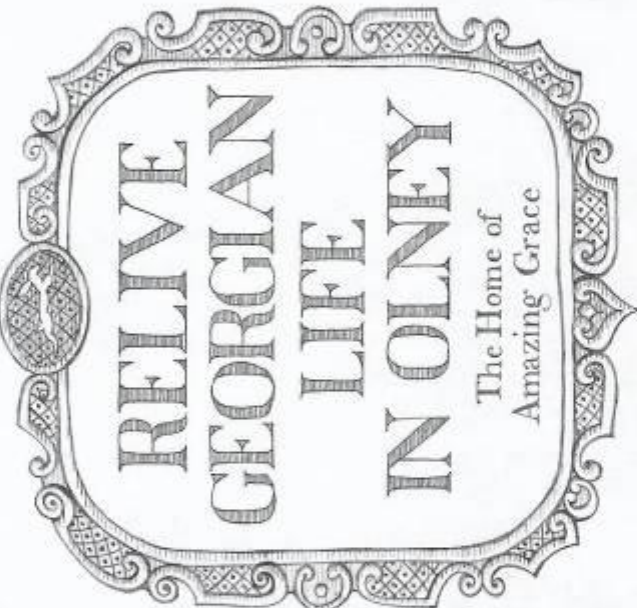

Historic townhouse,  
 Tranquil gardens  
 and some of the  
 Greatest Stories  
 of the Era



Cowper's Sofa



Georgian Party Dress

## Relive Georgian Life in Olney

Walk back in time through the home of William Cowper, renowned 18th century poet, featuring numerous personal artefacts and belongings. Discover Cowper's comic sense of humour, his poetry and writings, his dark depressions and his love of gardening and animals - especially his pet hares.

"Absence of occupation is not rest;  
 A mind quite vacant is a mind distressed."  
 William Cowper



Lady Austen's Fan



Cameo Ring in Case

## Relax in the Tranquil Gardens

Enjoy the sensory pleasures of two peaceful gardens. The historically significant walled flower garden with its numerous plants, shrubs and flowers of pre-1800 species. The Summer House Garden with its 300 year old garden house, medicinal plants, herbs and heritage fruit and vegetables all maintained organically.

"They whom truth and wisdom lead,  
 can gather honey from a weed"  
 William Cowper

# COWPER & NEWTON MUSEUM

## RATES - 2023

### Group 10 visitors and MORE ...

<b>PRE-BOOKED SELF LED</b>	Previously purchased Annual Admission Ticket and approved 2-for-1 Pass NOT VALID Adult museum and gardens = £9 (No concessions) Adult gardens only = £3.50 Group organiser = Free Child: Under 16 years = Free (Children must be accompanied by an adult. School visit – see fees below) Deposit £25 (to be deducted from overall fee, or retained should cancellation be less than 1 week's notice).
<b>PRE-BOOKED + TOUR GUIDE</b>	Previously purchased Annual Admission Ticket and approved 2-for-1 Pass NOT VALID Cowper & Newton Museum Tour Guide fee for introductory talk and/or full tour = £30 Adult: £9 (No concessions) Group organiser = Free Child: Under 16 years = Free (Children must be accompanied by an adult) Deposit £25 (to be deducted from overall fee, or retained should cancellation be less than 1 week's notice).
<b>PRE-BOOKED OLNEY TOWN TOUR</b>	Previously purchased Annual Admission Ticket and approved 2-for-1 Pass NOT VALID Subject to Town Tour Guide availability. Tour guide fee: Included in the price Adult: £9 (No concessions) Group organiser = Free Child: Under 16 years = Free (Children must be accompanied by an adult. School visit – see fees below) Deposit £25 (to be deducted from overall fee, or retained should cancellation be less than 1 week's notice).

### Group LESS THAN 10 visitors ...

<b>SELF-LED</b>	Usual admission rates apply – see our website for details
<b>PRE-BOOKED + TOUR GUIDE</b>	Previously purchased Annual Admission Ticket and all 2-for-1 Pass NOT VALID Cowper & Newton Museum Tour Guide fee for introductory talk and/or full tour = £30 Minimum charge £50 = Adult: £9 (No concessions) Group organiser = Free Child: Under 16 years = Free (Children must be accompanied by an adult). (School visit – see fees below) Deposit £25 (to be deducted from overall fee, or retained should cancellation be less than 1 week's notice).
<b>PRE-BOOKED OLNEY TOWN TOUR</b>	Previously purchased Annual Admission Ticket and all 2for1 Pass NOT VALID Subject to Town Tour Guide availability. Tour guide fee: Included in the price Minimum fee £30 (1-4 people) for a Cowper & Newton Museum Town Tour Guide Adult: £9 (No concessions) (5 people and above) Group organiser = Free Child: Under 16 years = Free (Children must be accompanied by an adult. School visit – see fees below) Deposit £25 (to be deducted from overall fee, or retained should cancellation be less than 1 week's notice).

### School Classes, External talks, Refreshments and Shop, Venue hire ...

<b>SCHOOL TALKS/ SCOUTS &amp; GUIDES</b>	Educational visits to museum - Sessions 1.5 hours. 10 children and over = £3 per child 5-16 years / Under 10 children minimum fee = £30. One (free) adult to every 6 children. Additional adult £9 per person (from 17 years). Our rooms are small - children will be split into groups. Please make sure each group is accompanied by a DBS checked adult. Talks at your school = request fee. Also 'Pre-booked Olney Town Tour' for details.
<b>ACADEMIC RESEARCH</b>	Academic research visit – please contact the Museum to discuss. Previously purchased Annual Admission Ticket and all 2-for-1 Pass NOT VALID
<b>HOME SCHOOL + TOUR GUIDE</b>	10 children and over = £3 per child 5-16 years / Under 10 children minimum fee = £30 One (free) adult to every 6 children. Additional adult £9 per person (from 17 years). Our rooms are small - children will be split into groups. Also see 'Pre-booked Olney Town Tour' for details of town tour.
<b>OUTREACH TALKS</b>	We are happy to respond to requests for speakers for local societies = £75 per talk in person or online *Occasionally it is necessary to levy a charge to cover transport costs at 25p per mile.
<b>REFRESHMENTS</b>	Must be pre-booked. Tea, coffee and biscuits in the museum Courtyard (May to Sept) = £4 per person.
<b>PRE-ORDER SHOP ITEMS</b>	Our museum shop has unique items and great gift ideas. View a selection of these on our website – click on 'Visit Us!' and 'The Shop'. You can pre-order ready to collect on your visit – 01234 711516/ 24 hours notice.
<b>VENUE HIRE</b>	Please email <a href="mailto:group@cowperandnewtonmuseum.org.uk">group@cowperandnewtonmuseum.org.uk</a> for details and availability.

# COWPER & NEWTON MUSEUM

## Your details

Trip/ Programme/ Coach organiser:			
Phone:			
Email:			
Name of Club/ Group visiting:			
Club/ Group Leader:			
Leader phone:			
Leader email:			
Leader Address (if not on email):			
Date of visit/ talk:			
Your itinerary:	Arrival time:	Departure time:	Refreshment time:
Number in Group:	Adults:	Children:	Age of children:
Venue address for Talks:			
Theme/ Special request:			
*Special access needs:			
How did you hear about us?			

**Requests (tick, bold, red text or circle your choices):** NB All subject to Volunteer availability – please contact the House Manager.

Introductory talk by Tour Guide, then self-led in museum and gardens	Introductory talk by Tour Guide, then guide-led in museum and gardens	Introductory talk, then self-led in gardens	Introductory talk, then guide-led in gardens
Self-led tour No Tour Guide	Olney Town tour with Tour Guide – theme tba	School trip (details to be discussed separately)	Academic Research Visit
Talk at Group's Venue/ other venue	Talk via online via Zoom	Refreshments (May- Sept served outside)	Bring Pop-Up Shop to the Talk's venue
Hire Museum Venue (as agreed with House Manager)			

## How to pay (tick, bold, red text or circle your choices):

Pounds (£) sterling. Pay 'Cowper Memorial Museum'

Bacs payment <i>Sort code 20-05-74 A/C 80294616</i>	Raise an invoice for our Treasurer:	Raise an invoice to match the voucher from the group leader on visit day	Cheque no enclosed:
Credit card (1) by email payment link (2) on the day	Deposit £25 paid date:  Cheque no:	Balance left to pay: Date paid:	

*As we are a volunteer-run charity with no external funding it would be appreciated if you could pay **BEFORE** your visit. **If paying by cash on the day, please bring the correct change to speed up the admission process.***

\* **Disabled access:** Wheelchair/mobility scooter access to Viper Barn (short intro film). Cowper's Kitchen, Hall and Parlour accessible by 1-2 shallow steps. Short films to watch in the Shop area for those unable to manage our stairs (over 3 floors). Museum has 6 small flights of stairs. Gardens have some narrow uneven paths. If you have people in your party that may struggle to keep up with a guided tour, the Introductory Talk then self-led option allows groups to go at their own pace.

\* **To visit St Peter and St Paul Church:** Contact the Church Administrator on 01234 241721 or [office@olney.church](mailto:office@olney.church)

<b>OFFICE USE ONLY</b>	Booking request date: Confirmed booking with organiser date: Acknowledged receipt of deposit <input type="checkbox"/> balance <input type="checkbox"/> St Peter and St Paul Church informed: Yes/ No	Name(s) of Tour Guides/ Stewards:  Name of Refreshment organiser:	On calendar: Yes/ No On G&E spreadsheet date: Veranda needed? Yes/ No In costume: Yes/ N
------------------------	---	---	---